



FITTING INSTRUCTIONS FOR CP0425BL
RACE AERO CRASH PROTECTORS
HONDA CBR 250RR 2017

Page | 1



Picture A



Picture B

THIS KIT CONTAINS THE ITEMS PICTURED AND LABELLED BELOW.
DO NOT PROCEED UNTIL YOU ARE SURE ALL PARTS ARE PRESENT.

Please note that the way the kit is packed does not necessarily represent the way of mounting to the bike.

THE PARTS SHOWN MAY BE REPRESENTATIVE ONLY (FOR CLARITY OF INSTRUCTIONS ONLY).

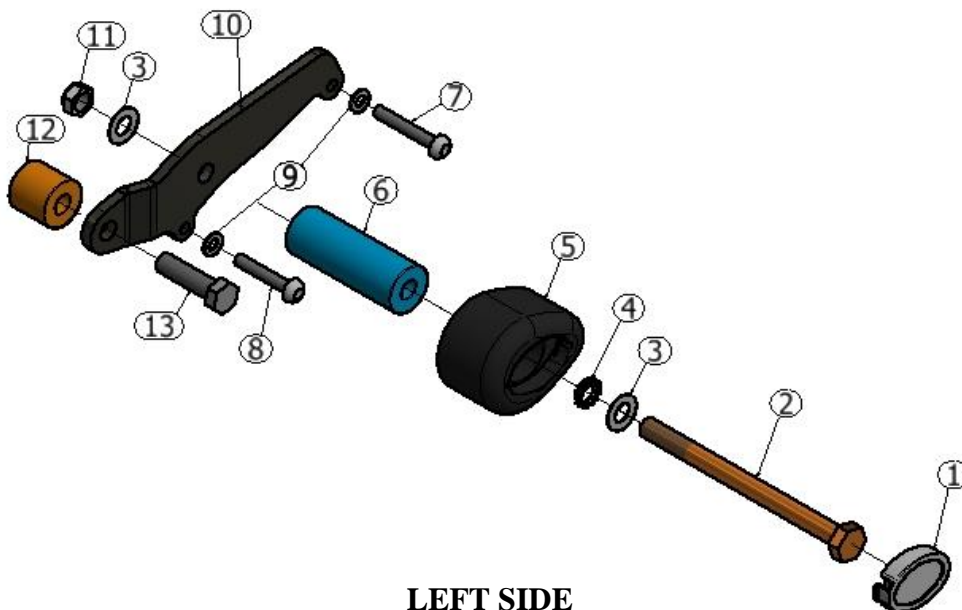

LEFT SIDE

R&G Racing
 Unit 1, Shelley's Lane, East Worldham, Alton, Hampshire, GU34 3AQ
 Tel: +44 (0)1420 89007 Fax: +44 (0)1420 87301 www.rg-racing.com Email: info@rg-racing.com

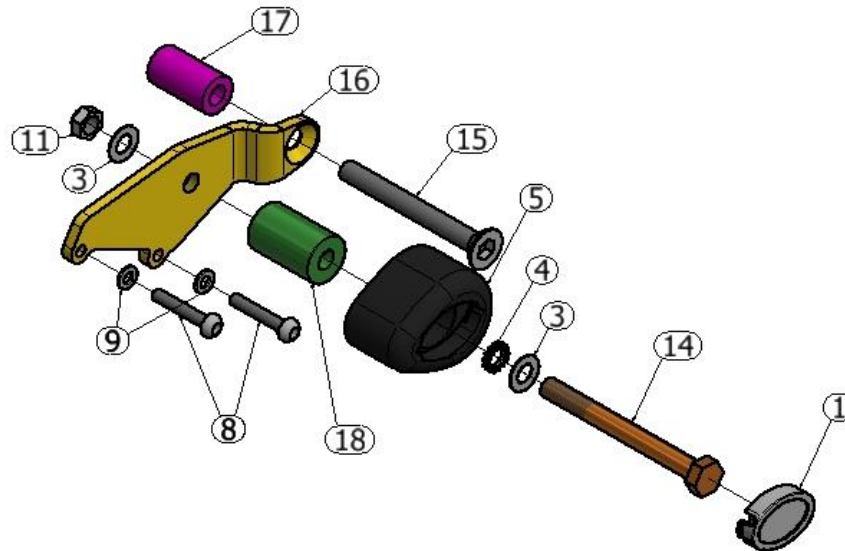

RIGHT SIDE

LEGEND

- ITEM 1 = CRASH PROTECTOR CAPS (BC0002) (x2).
 ITEM 2 = M10 x 1.25 x 110mm LONG HEX HEAD BOLT (x1).
 ITEM 3 = M10 WASHERS (x4).
 ITEM 4 = LOCK-WASHERS (LW0001) (x2).
 ITEM 5 = CRASH PROTECTOR BOBBINS (B0472 with CS449) (x2).
 ITEM 6 = SPACER (S1010 – 70mm LONG) (x1).
 ITEM 7 = M6 x 40mm LONG BUTTON HEAD BOLT (x1)
 ITEM 8 = M6 x 35mm LONG BUTTON HEAD BOLT (x3)
 ITEM 9 = M6 WASHERS (x4)
 ITEM 10 = LHS MOUNTING BRACKET (PLATE 0203) (x1)
 ITEM 11 = M10 NYLOC NUTS (x2)
 ITEM 12 = SPACER (S0011 – 24mm LONG) (x1)
 ITEM 13 = OEM ENGINE BOLT LHS – *for illustration purpose only; not supplied in the kit*
 ITEM 14 = M10 x 75mm LONG HEX HEAD BOLT (x1)
 ITEM 15 = M10 x 85mm LONG COUNTERSUNK BOLT (x1)
 ITEM 16 = RHS MOUNTING BRACKET (PLATE 0204) (x1)
 ITEM 17 = SPACER (S1009 – 37mm LONG) (x1)
 ITEM 18 = SPACER (S1011 – 40mm LONG) (x1)

Please note that in cases where kits are packed with rubber washers holding the components onto the bolt – *the rubber washers should be thrown away!*

TOOLS REQUIRED

- 4mm & 5mm Allen Key.
- Socket set to include 14mm & 17mm socket and wrench.
 - Torque wrench (up to 40N/m).
 - 17mm spanner

R&G Racing

Unit 1, Shelley's Lane, East Worldham, Alton, Hampshire, GU34 3AQ

Tel: +44 (0)1420 89007 Fax: +44 (0)1420 87301 www.rg-racing.com Email: info@rg-racing.com



TOWARDS REAR
OF BIKE



TOWARDS FRONT
OF BIKE

PICTURE C

GENERAL TORQUE SETTINGS

- M4 BOLT = 8Nm
- M5 BOLT = 12Nm
- M6 BOLT = 15Nm
- M8 BOLT = 20Nm
- M10 BOLT = 40Nm



PICTURE 1

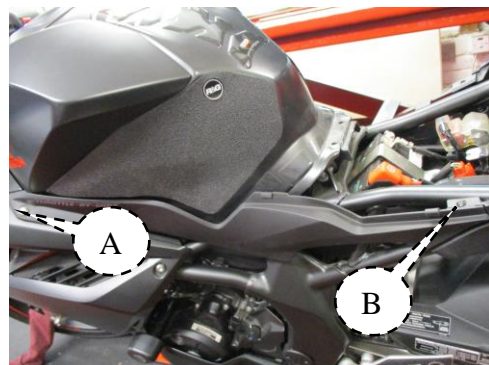

PICTURE 2

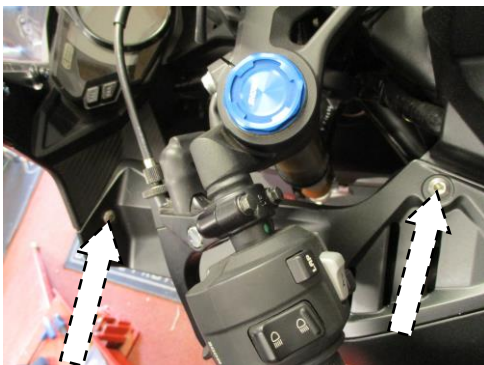

PICTURE 3



PICTURE 4



PICTURE 5

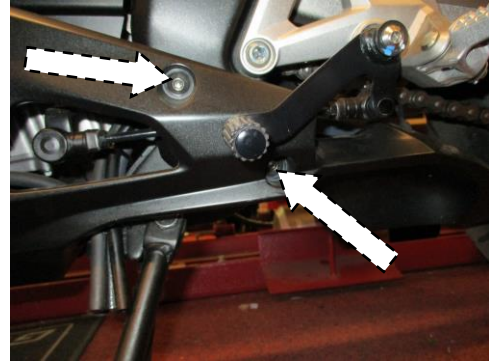

PICTURE 6

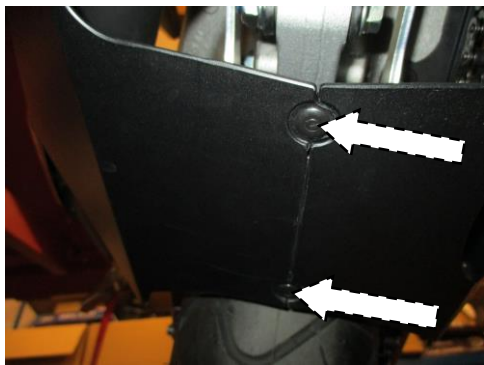

PICTURE 7

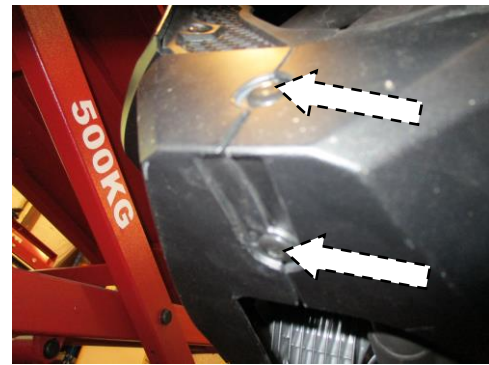

PICTURE 8



PICTURE 9



PICTURE 10

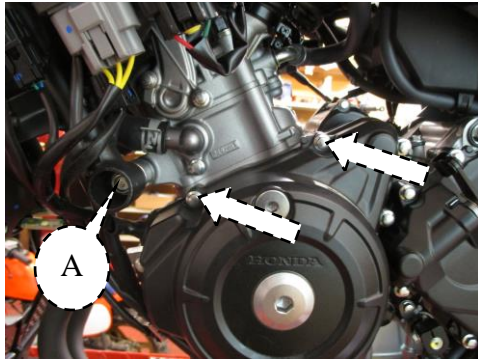

PICTURE 11

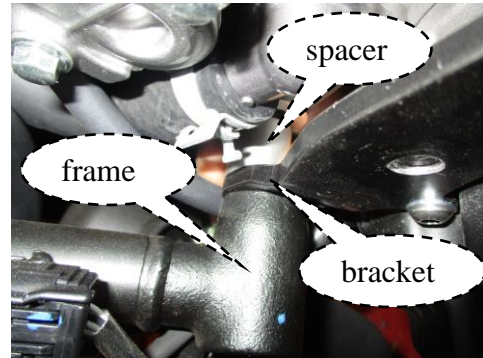

PICTURE 12

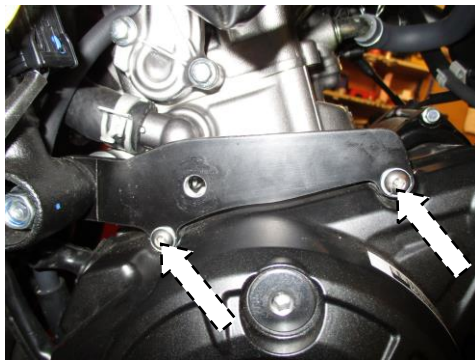

PICTURE 13

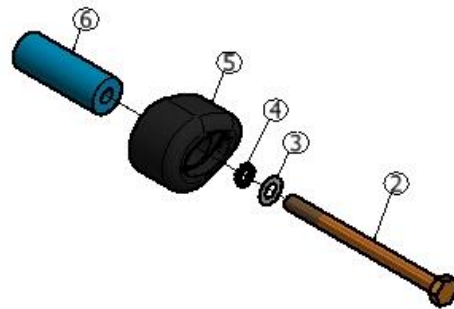

PICTURE 14



PICTURE 15



PICTURE 16

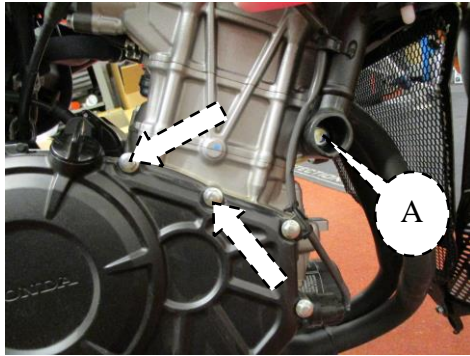

PICTURE 17

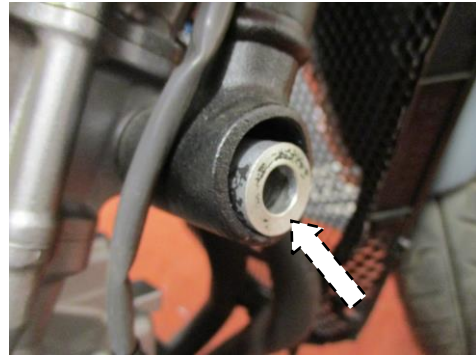

PICTURE 18

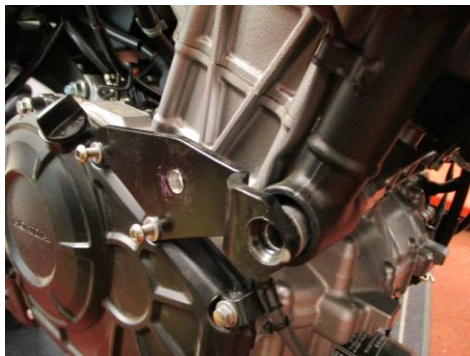

PICTURE 19

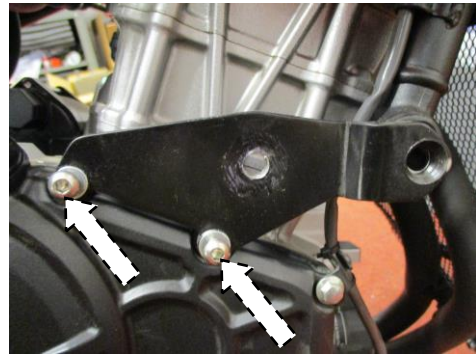

PICTURE 20

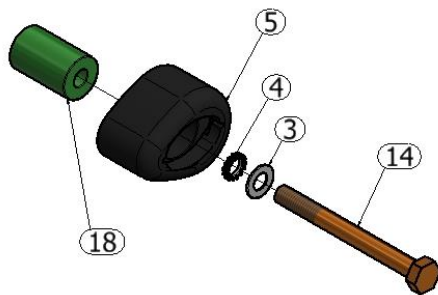

PICTURE 21



FITTING INSTRUCTIONS

Page | 7

- To fit R&G crash protector, both fairings need to be removed. Starting from LHS fairing (as you sit on the bike); from the underside of the rider seat, remove the two black bolts and its spacers using 10mm socket and a wrench, labelled A in Picture 1. Remove the rider seat.
- From picture 2, remove bolt A using 5mm Allen key and screw B using a phillips screwdriver. Remove the LHS panel by sliding it off backwards.
- From the upper top LHS fairing, remove the two bolts arrowed in Picture 3 using 5mm Allen key.
- From the inside of the same panel, remove the push-in pin arrowed in Picture 4. Push the centre of the pin then remove the whole pin unit.
- On the mid area of the LHS fairing, remove the bolt arrowed in Picture 5 using a 5mm Allen key.
- On the lower side rear of the LHS fairing, remove the two bolts arrowed in Picture 6 using a 5mm Allen key.
- On the underside rear of the LHS fairing, remove the two push-in pins arrowed in Picture 7.
- On the underside front of the LHS fairing, remove the two push in pins arrowed in Picture 8.
- On the inside upper LHS fairing, remove the push-in pin arrowed in Picture 9.
- On the inside mid and lower LHS fairing, remove the two push-in pins arrowed in Picture 10.
- Gently unclip the LHS fairing from the infill panel. Once fully unclipped, gently pull the fairing away from the bike.
- Repeat the whole procedures to the RHS fairing.
- On the LHS of the engine, remove engine bolt A (as shown in Picture 11) using a 14mm socket and a wrench. Remove the bolt and the OEM spacer located behind the frame.
- Remove the two engine case bolts arrowed in Picture 11 using an 8mm socket and a wrench. Please note that the bolt sits furthest back is longer than the other bolt.
- From the kit, take the LHS mounting bracket (Item 10) and a 24mm long spacer (Item 12). Locate the big end of the mounting bracket (item 10) behind the frame follows by the spacer to sit between the engine and the mounting bracket (As shown in Picture 12). Also align the two small mounting holes to the engine case. Loosely fit the OEM engine bolt removed earlier as original.
- From the kit, take the longer M6 bolt (Item 7), one shorter M6 bolt (Item 8) and two M6 washers (Item 9). Place the washer to each bolt and locate the longer M6 bolt (Item 7) to the furthest back mounting point of the bracket. Fit the other bolts and the washer to the other mounting point of the bracket as shown in Picture 13. Tighten all bolts including the engine mount bolt to specified torque settings.
- From the kit, take the M10 x 110mm long bolt (Item 2). Locate one M10 washer (Item 3) follow by an M10 lock washer (Item 4) to the bolt. Insert one crash protector bobbin (Item 5) follow by a 70mm spacer (Item 6) (Assembly shown in Picture 14).
- Loosely fit the assembly to the LHS mounting bracket (as shown in picture 15) until the protruded end of the bolt starting to show on the other side of the mounting bracket. Place an M10 washer (Item 3) and an M10 nyloc nut (Item 11) to that protruded end (as shown in picture 16).
- Tighten the crash protector bolt until you feel some compression from inside the protector using a 17mm socket and wrench. **PLEASE NOTE THE CRASH PROTECTOR MUST BE POSITIONED AS IN PICTURE 'C' WITH BIGGER END TOWARD FRONT OF BIKE.** Turn a little more so that you feel the compression increase slightly. Then apply a

R&G Racing

Unit 1, Shelley's Lane, East Worldham, Alton, Hampshire, GU34 3AQ

Tel: +44 (0)1420 89007 Fax: +44 (0)1420 87301 www.rg-racing.com Email: info@rg-racing.com



- quarter turn. Do not over tighten as damage can occur to the bike. Do not exceed 40N/m of torque. Tighten the M10 nyloc nut using a 17mm open-ended spanner.
- Fit crash protector cap (Item 1) to the end of crash protector bobbin just fitted.
 - On the RHS of the engine, remove the OEM engine bolt (labelled A in Picture 17) using a 14mm socket and a wrench.
 - Remove the two engine case bolts arrowed in Picture 17 using an 8mm socket and a wrench.
 - From the kit, take the RHS mounting bracket (Item 16) and a 37mm long spacer (Item 17). Place the spacer inside the frame on the RHS (as shown in picture 18) then locate the mounting bracket (Item 16) in front of the spacer (as shown in Picture 19). Loosely fit the M10 countersunk bolt (Item 15) from the kit to big end mounting point. Align the other two small mounting holes to the RHS engine case in the process.
 - From the kit, take the remaining two M6 bolts (Item 8) and two M6 washers (Item 9), place the washer to each bolt and offer to each small mounting point on the mounting bracket (Item 16) as shown in Picture 20. Tighten all bolts including the engine bolt just fitted to specified torque settings.
 - From the kit, assemble the remaining M10 x 75mm long bolt with an M10 washer (Item 3), M10 lock washer (Item 4), a crash protector bobbin (Item 5) and a 40mm long spacer (Item 18) as shown in picture 21.
 - Loosely fit the assembly to the RHS mounting bracket until the protruded end of the bolt starting to show on the other side of the bracket. Place an M10 washer (Item 3) and an M10 nyloc nut (Item 11) to that protruded end.
 - Tighten the crash protector bolt until you feel some compression from inside the protector using a 17mm socket and wrench. **PLEASE NOTE THE CRASH PROTECTOR MUST BE POSITIONED AS IN PICTURE 'C' WITH BIGGER END TOWARD FRONT OF BIKE.** Turn a little more so that you feel the compression increase slightly. Then apply a quarter turn. Do not over tighten as damage can occur to the bike. Do not exceed 40N/m of torque. Tighten the M10 nyloc nut using an open-ended 17mm spanner.
 - Fit crash protector cap (Item 1) to the end of crash protector bobbin just fitted.
 - Please ensure that the assembly accuracy of the fitted components is the same as exploded diagram shown in page 1.
 - If not already fitted, fit bubble stickers into recess of both crash protector caps.
 - Refit fairings as original.
 - Refit side panels as original.
 - Refit rider seat as original.

ISSUE 1 15/05/2017 (HH)

Digital copies of these instructions are available to download from www.rg-racing.com

CONSUMER NOTICE

The catalogue description and any exhibition of samples are only broad indications of the Products and R&G may make design changes which do not diminish their performance or visual appeal and supplying them in such state shall conform to the order. The Buyer acknowledges no representation or warranty (other than as to title) has been given or will apply to the Products other than those in R&G's order or confirmation and the Buyer confirms it has chosen the Products as being of merchantable quality and suitable for its particular purposes. Where R&G fits the Products or undertakes other services it shall exercise reasonable skill and care and rectify any fault free of charge unless the workmanship has been disturbed. The Buyer is responsible for ensuring that the warranty on the motorcycle is not affected by the fitting of the Products. On return of any defective Products R&G shall at its option either supply a replacement or refund the purchase money but shall not be liable if the Products have been modified or used or maintained otherwise than in accordance with R&G's or manufacturer's instructions and good engineering practice or if the defect arises from accident or neglect. Other than identified above and subject to R&G not limiting its liability for causing death and personal injury, it shall not be liable for indirect or consequential loss and otherwise its liability

R&G Racing

Unit 1, Shelley's Lane, East Worldham, Alton, Hampshire, GU34 3AQ

Tel: +44 (0)1420 89007 Fax: +44 (0)1420 87301 www.rg-racing.com Email: info@rg-racing.com



shall be limited to the amounts paid by the Buyer for the Products or the fitting or service concerned. These terms do not affect the Buyer's statutory rights.

R&G RACING RETURNS POLICY (NON-FAULTY GOODS)

Returns must be pre-authorized (if not pre-authorized the return will be rejected). Goods may only be returned direct to us if they were purchased direct from us (customer must prove if necessary). Otherwise to be returned to original vendor. Goods must be in re-sellable condition, in the opinion of R&G Racing. All returns are subject to a 25% restocking and handling fee (25% of the gross value exc. P&P – at the prevailing price at time of purchase). The customer must pay any and all carriage charges. No returns of discontinued products, unless within 14 days of purchase. This policy does not affect your statutory rights and does not refer to faulty goods.



NOTICE DE MONTAGE POUR CP0425BL
PROTECTIONS CRASH
HONDA CBR 250RR 2017

Page | 10



Photo A

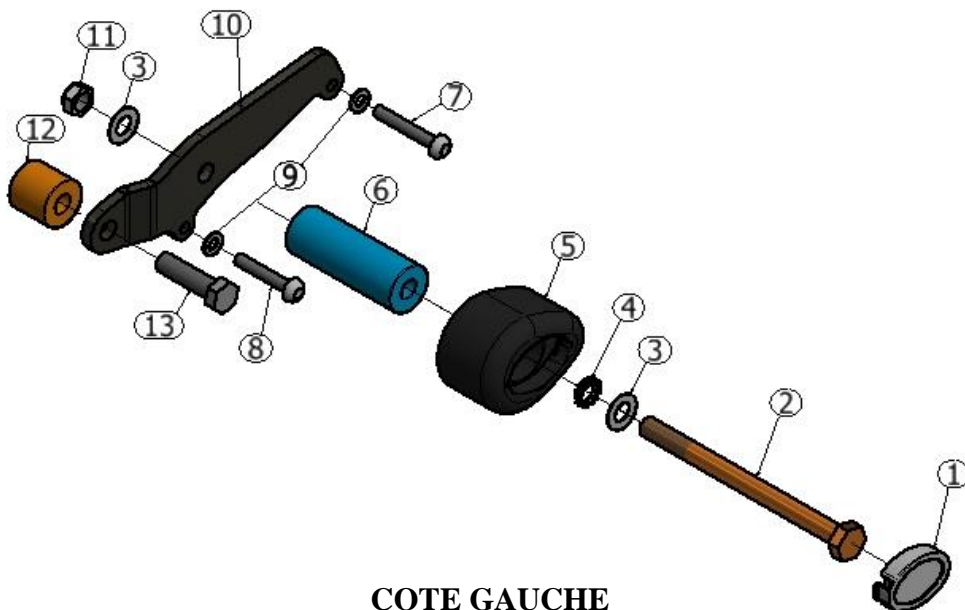

Photo B

LE KIT CONTIENT LES ARTICLES EXPOSES CI-DESSOUS, VERIFIER QUE TOUTES LES PIECES SOIENT PRESENTES AVANT DE PROCEDER AU MONTAGE.

LA FAÇON DONT LE KIT EST EMBALLE NE CORRESPOND PAS FORCEMENT A LA FAÇON DE MONTER LES PIECES SUR LA MOTO.

LES PARTIES PRESENTEES PEUVENT ETRE UNIQUEMENT REPRESENTATIVES (POUR LA CLARTE DES INSTRUCTIONS UNIQUEMENT).



COTE GAUCHE

R&G Racing
 Unit 1, Shelley's Lane, East Worldham, Alton, Hampshire, GU34 3AQ
 Tel: +44 (0)1420 89007 Fax: +44 (0)1420 87301 www.rg-racing.com Email: info@rg-racing.com

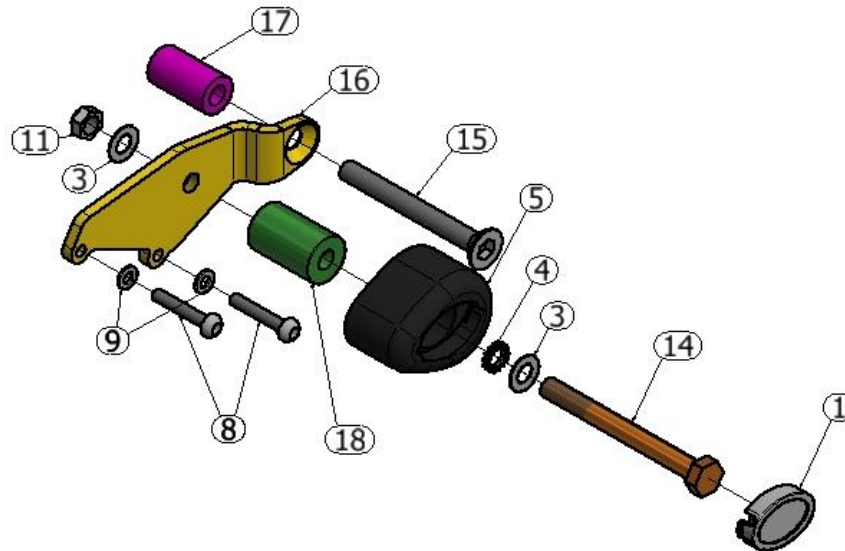

COTE DROIT

LEGENDE

- ARTICLE 1 = CAPUCHONS DE PROTECTION CRASH (BC0002) (x2).
 ARTICLE 2 = M10x1.25x 110mm BOULON (x1).
 ARTICLE 3 = M10 RONDELLES (x4).
 ARTICLE 4 = RONDELLES DE BLOCAGE (LW0001) (x2).
 ARTICLE 5 = BOBINES DE PROTECTION CRASH (B0472 avec CS449) (x2).
 ARTICLE 6 = ENTRETOISE (S1010 – 70mm DE LONG) (x1).
 ARTICLE 7 = M6 x 40mm BOULON (x1)
 ARTICLE 8 = M6 x 35mm BOULON (x3)
 ARTICLE 9 = M6 RONDELLES (x4)
 ARTICLE 10 = SUPPORT DE FIXATION GAUCHE (PLAQUE 0203) (x1)
 ARTICLE 11 = M10 ECROUS (x2)
 ARTICLE 12 = ENTRETOISE (S0011 – 24mm DE LONG) (x1)
 ARTICLE 13 = BOULON D'ORIGINE DU COTE GAUCHE– *Pour illustrer uniquement, non fourni dans le kit.*
 ARTICLE 14 = M10 x 75mm BOULON (x1)
 ARTICLE 15 = M10 x 85mm BOULON (x1)
 ARTICLE 16 = SUPPORT DE FIXATION DROIT (PLAQUE 0204) (x1)
 ARTICLE 17 = ENTRETOISE (S1009 – 37mm DE LONG) (x1)
 ARTICLE 18 = ENTRETOISE (S1011 – 40mm DE LONG) (x1)

Notez que si les kits sont emballés avec des rondelles en caoutchouc servant à tenir les composants sur le boulon, *ces rondelles doivent être jetées!*

OUTILS REQUIS

- Clé et douilles 4, 5mm.



- Clés 14mm & 17mm.
- Clé dynamométrique (à 40Nm).
- Clé à molette 17mm

Page | 12 ARRIERE MOTO

AVANT MOTO



PHOTO C

COUPLES DE SERRAGE RECOMMANDES

M4 BOULON = 8Nm
 M5 BOULON = 12Nm
 M6 BOULON = 15Nm
 M8 BOULON = 20Nm
 M10 BOULON = 40Nm



PHOTO 1

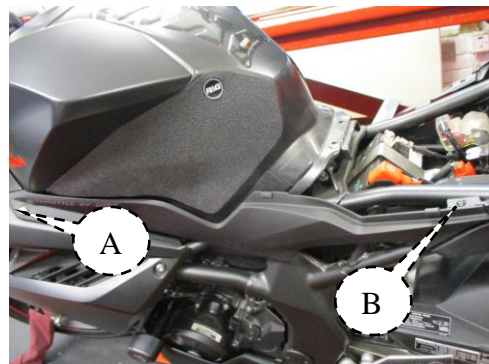

PHOTO 2

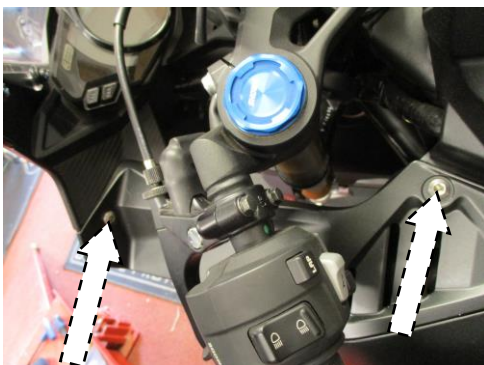

PHOTO 3



PHOTO 4



PHOTO 5

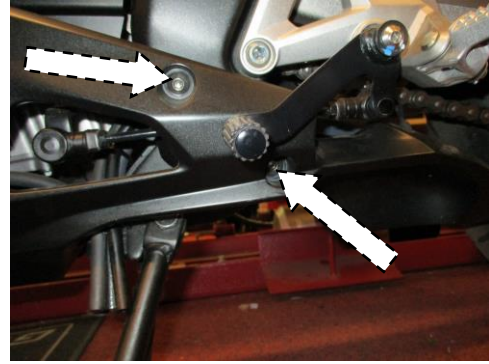

PHOTO 6

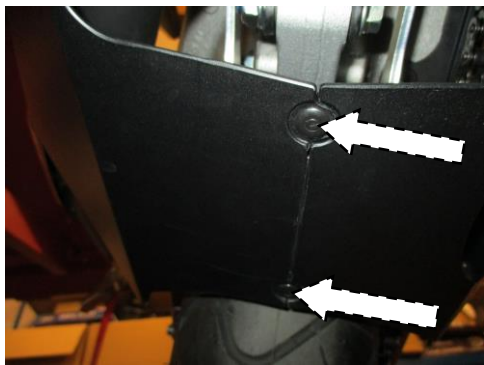

PHOTO 7

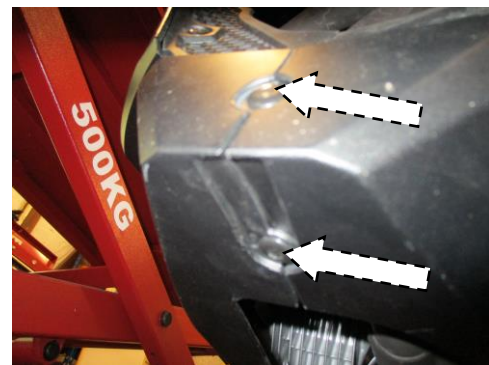

PHOTO 8

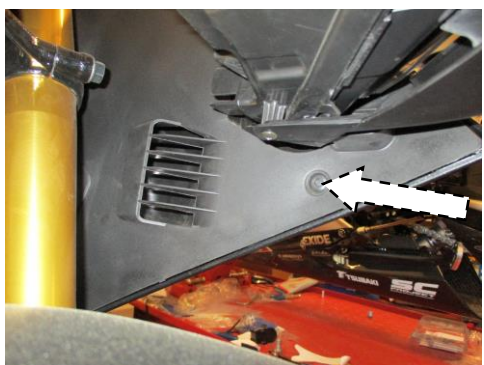

PHOTO 9



PHOTO 10

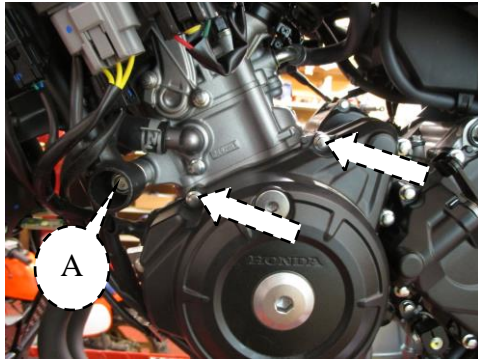

PHOTO 11

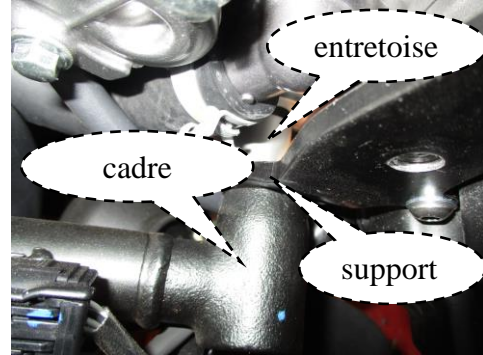

PHOTO 12

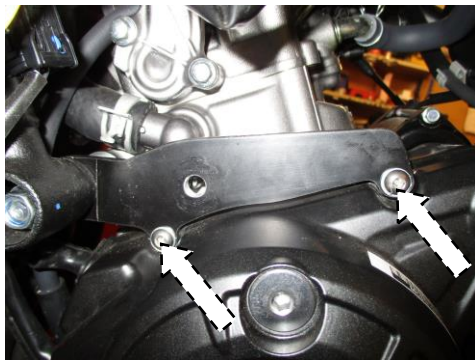

PHOTO 13

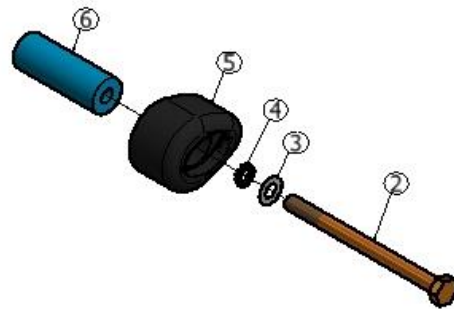

PHOTO 14



PHOTO 15



PHOTO 16

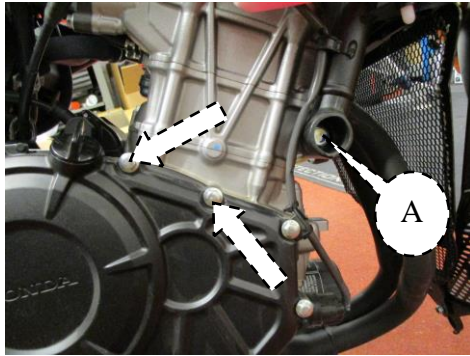

PHOTO 17

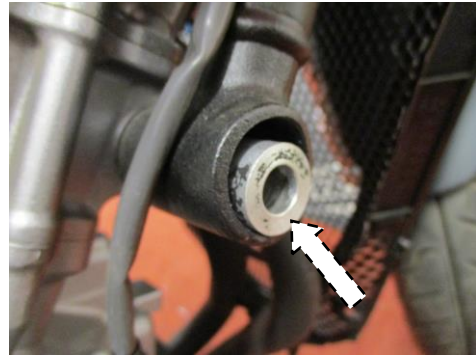

PHOTO 18

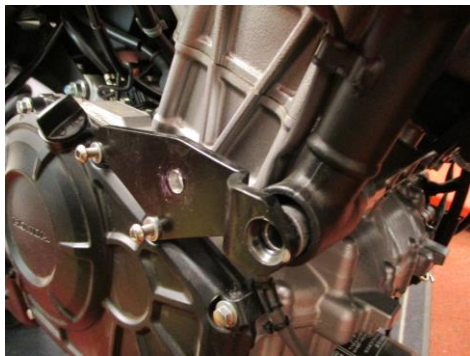

PHOTO 19

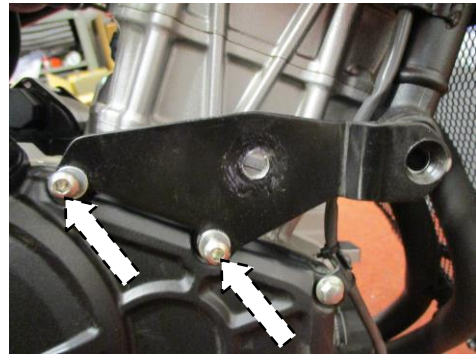

PHOTO 20

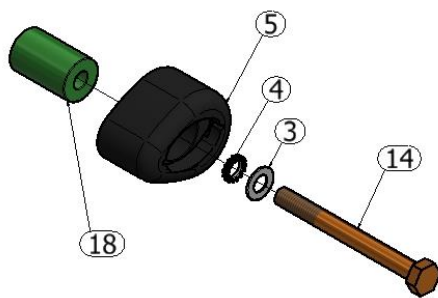

PHOTO 21

NOTICE DE MONTAGE



- Pour monter les protections, les 2 carénages doivent être enlevés de la moto. En partant du carénage gauche (lorsqu'on est assis sur la moto); depuis le dessous du siège pilote, enlever les 2 boulons et leurs entretoises en utilisant une clé 10mm, indiqué A sur la Photo 1. Enlever le siège pilote.
- Sur la photo 2, enlever le boulon A en utilisant une clé Allen 5mm et visser B en utilisant un tournevis cruciforme. Enlever le panneau gauche en le glissant vers le bas.
- Depuis le haut du carénage gauche, enlever les 2 boulons indiqués sur la photo 3 en utilisant une clé Allen 5mm.
- Depuis l'intérieur du même panneau, enlever la broche indiquée sur la photo 4. Pousser le centre de la broche puis retirer l'ensemble des broches.
- Sur le milieu du carénage gauche, enlever le boulon indiqué sur la photo 5 en utilisant une clé Allen 5mm.
- Sur le bord inférieur arrière du carénage gauche, enlever les 2 boulons indiqués sur la photo 6 en utilisant une clé Allen 5mm.
- Au dessous du carénage arrière gauche, enlever les 2 broches présentes sur la photo 7.
- Au dessous du carénage avant gauche, enlever les 2 broches indiquées sur la photo 8.
- A l'intérieur du carénage supérieur gauche, enlever la broche indiquée sur la photo 9.
- A l'intérieur du carénage gauche inférieur et intermédiaire, enlever les 2 broches indiquées sur la photo 10.
- Déclipser le carénage gauche du panneau interne. Une fois déclipé, tirer le carénage de la moto.
- Répéter les procédures pour le carénage droit.
- Du côté gauche du moteur, enlever le boulon moteur A (voir photo 11) en utilisant une clé 14mm. Enlever le boulon et l'entretoise d'origine placée derrière le cadre.
- Enlever les 2 boulons de carter moteur indiqués sur la photo 11 en utilisant une clé 8mm. Notez que le boulon qui se place le plus loin est plus long que l'autre boulon.
- Dans le kit, prendre le support de fixation gauche (Article 10) et une entretoise 24mm (Article 12). Placer la grosse extrémité du support de fixation (article 10) derrière le cadre suivi d'une entretoise qui doit se placer entre le moteur et le support de fixation (voir Photo 12). Aligner les 2 petits trous de fixation sur le carter moteur. Monter le boulon moteur d'origine enlevé plus tôt, comme à l'origine.
- Dans le kit, prendre le boulon M6 (Article 7), un boulon M6 (Article 8) et 2 rondelles M6 (Article 9). Placer une rondelle sur chaque boulon et placer le long boulon M6 (Article 7) sur le point de fixation du support le plus en retrait. Insérer les autres boulons et la rondelle sur l'autre point de fixation du support, voir Photo 13. Serrer tous les boulons, en incluant le boulon de fixation moteur selon les valeurs de serrage recommandées.
- Dans le kit, prendre le boulon M10 x 110mm (Article 2). Placer une rondelle M10 (Article 3) suivie d'une rondelle de blocage M10 (Article 4) sur le boulon. Insérer une protection crash (Article 5) suivie d'une entretoise 70mm (Article 6) (Assemblage monté sur la Photo 14).
- Monter l'ensemble sans serrer sur le support de fixation du côté gauche (voir photo 15) jusqu'à ce que l'extrémité dépassant du boulon commence à dépasser de l'autre côté du support de fixation. Placer une rondelle M10 (Article 3) et un écrou M10 (Article 11) sur cette extrémité (voir photo 16).
- Serrer le boulon de la protection jusqu'à ce que vous sentiez une compression de l'intérieur de la protection avec une clé de 17mm. **LA PROTECTION DOIT ETRE POSITIONNEE COMME EN "C" AVEC LE CÔTÉ ARRONDI LE PLUS GROS EN DIRECTION DE L'AVANT DE LA MOTO.**

R&G Racing

Unit 1, Shelley's Lane, East Worldham, Alton, Hampshire, GU34 3AQ

Tel: +44 (0)1420 89007 Fax: +44 (0)1420 87301 www.rg-racing.com Email: info@rg-racing.com



- Tourner un peu plus afin d'accentuer légèrement la compression. Faire un quart de tour. Ne pas excéder 40Nm de couple. Serrer l'écrou M10 avec une clé plate de 17mm.
- Insérer le capuchon de la protection crash (Article 1) sur l'extrémité de la bobine de protection crash tout juste montée.
 - Du côté droit du moteur, enlever le boulon moteur d'origine (indiqué A sur la Photo 17) en utilisant une clé à molette de 14mm.
 - Enlever les 2 boulons de carter moteur indiqués sur la Photo 17 en utilisant une clé à molette de 8mm.
 - Dans le kit, prendre le support de fixation droit (Article 16) et une entretoise de 37mm (Article 17). Placer l'entretoise dans le cadre du côté droit (voir photo 18) puis placer le support de fixation (Article 16) devant l'entretoise (voir Photo 19). Insérer le boulon M10 (Article 15) du kit sur la grosse extrémité du point de fixation. Aligner les 2 autres trous de fixation sur le carter moteur du côté droit dans le process.
 - Dans le kit, prendre les 2 boulons M6 restants (Article 8) et les 2 rondelles M6 (Article 9), placer la rondelle sur chaque boulon et placez-les sur chaque petit point de fixation du support de fixation (Article 16) voir Photo 20. Serrer tous les boulons, et le boulon moteur tout juste inséré, aux valeurs de serrage recommandées.
 - Dans le kit, assembler le boulon restant M10 x 75mm avec une rondelle M10 (Article 3), une rondelle de blocage M10 (Article 4), une bobine de protection crash (Article 5) et une entretoise 40mm (Article 18), voir photo 21.
 - Monter l'ensemble du côté droit du support de fixation jusqu'à ce que l'extrémité dépassant du boulon commence à dépasser de l'autre côté du support. Placer une rondelle M10 (Article 3) et un écrou M10 (Article 11) sur cette extrémité.
 - Serrer le boulon de la protection jusqu'à ce que vous sentiez une compression de l'intérieur de la protection avec une clé de 17mm. **LA PROTECTION DOIT ETRE POSITIONNEE COMME EN "C" AVEC LE CÔTÉ ARRONDI LE PLUS GROS EN DIRECTION DE L'AVANT DE LA MOTO.** Tourner un peu plus afin d'accentuer légèrement la compression. Faire un quart de tour. Ne pas excéder 40Nm de couple. Serrer l'écrou M10 avec une clé plate de 17mm.
 - Insérer le capuchon de protection crash (Article 1) sur l'extrémité de la protection crash tout juste montée.
 - Veiller à ce que l'ensemble ressemble avec précision au schéma page 1.
 - Si cela n'est pas déjà fait, placez un sticker de caoutchouc dans le creux des bouchons de chaque protection crash.
 - Remonter les carénages comme à l'origine.
 - Remonter les panneaux latéraux comme à l'origine.
 - Remonter le siège du pilote comme à l'origine.

ISSUE 1 15/05/2017 (HH)

Notice disponible au téléchargement sur www.rg-racing.com

CONSUMER NOTICE

The catalogue description and any exhibition of samples are only broad indications of the Products and R&G may make design changes which do not diminish their performance or visual appeal and supplying them in such state shall conform to the order. The Buyer acknowledges no representation or warranty (other than as to title) has been given or will apply to the Products other than those in R&G's order or confirmation and the Buyer confirms it has chosen the Products as being of merchantable quality and suitable for its particular purposes. Where R&G fits the Products or undertakes other services it shall exercise reasonable skill and care and rectify any fault free of charge unless the workmanship has been disturbed. The Buyer is responsible for ensuring that the warranty on the motorcycle is not affected by the fitting of the Products. On return of any defective Products

R&G Racing

Unit 1, Shelley's Lane, East Worldham, Alton, Hampshire, GU34 3AQ

Tel: +44 (0)1420 89007 Fax: +44 (0)1420 87301 www.rg-racing.com Email: info@rg-racing.com



R&G shall at its option either supply a replacement or refund the purchase money but shall not be liable if the Products have been modified or used or maintained otherwise than in accordance with R&G's or manufacturer's instructions and good engineering practice or if the defect arises from accident or neglect. Other than identified above and subject to R&G not limiting its liability for causing death and personal injury, it shall not be liable for indirect or consequential loss and otherwise its liability shall be limited to the amounts paid by the Buyer for the Products or the fitting or service concerned. These terms do not affect the Buyer's statutory rights.

Page | 18

R&G RACING RETURNS POLICY (NON-FAULTY GOODS)

Returns must be pre-authorized (if not pre-authorized the return will be rejected). Goods may only be returned direct to us if they were purchased direct from us (customer must prove if necessary). Otherwise to be returned to original vendor. Goods must be in re-sellable condition, in the opinion of R&G Racing. All returns are subject to a 25% restocking and handling fee (25% of the gross value exc. P&P – at the prevailing price at time of purchase). The customer must pay any and all carriage charges. No returns of discontinued products, unless within 14 days of purchase. This policy does not affect your statutory rights and does not refer to faulty goods.

R&G Racing

Unit 1, Shelley's Lane, East Worldham, Alton, Hampshire, GU34 3AQ

Tel: +44 (0)1420 89007 Fax: +44 (0)1420 87301 www.rg-racing.com Email: info@rg-racing.com